

MILWOOD SECTION TWENTY THREE

STATE OF TEXAS:
COUNTY OF TRAVIS:

KNOW ALL MEN BY THESE PRESENTS: THAT, MILWOOD JOINT VENTURE, II, A TEXAS JOINT VENTURE COMPOSED OF BILL MILBURN, INC. AND PALMAR ASSOCIATES, LTD., ORGANIZED UNDER THE LAWS OF THE STATE OF TEXAS, HAVING ITS HOME OFFICE IN AUSTIN, TEXAS, ACTING HEREIN BY AND THROUGH THE UNDERSIGNED ONE OF THAT CERTAIN TRACT OUT OF THE W.J. BAKER SURVEY NO. 10 AND THE W.J. BAKER SURVEY NO. 64, SITUATED IN TRAVIS AND WILLAMSON COUNTY, TEXAS, CONVEYED BY DEED RECORDED IN VOLUME 826, PAGE 372, OF THE TRAVIS COUNTY, TEXAS DEED RECORDS, AND IN DEED RECORDED IN VOLUME 946, PAGE 893, OF THE WILLAMSON COUNTY, TEXAS DEED RECORDS, DO HEREBY SUBDIVIDE 60.030 ACRES OF LAND, IN ACCORDANCE WITH THE ATTACHED MAP OR PLAT, TO BE KNOWN AS "MILWOOD SECTION TWENTY THREE", AND DO HEREBY DEDICATE TO THE PUBLIC, USE OF THE STREETS AND EASEMENTS SHOWN HEREON.

MILWOOD JOINT VENTURE, II
By: Bill Milburn, INC. JOINT VENTURER
By: *[Signature]*
BILL MILBURN, President P.O. BOX 4000 AUSTIN, TEXAS 78766

By: *[Signature]*
A.H. ROBINSON, III, General Partner
By: *[Signature]*
JOHN OSCAR ROBINSON, General Partner
P.O. BOX 8552
AUSTIN, TEXAS 78766

BEFORE ME, THE UNDERSIGNED AUTHORITY, ON THIS DAY PERSONALLY APPEARED BILL MILBURN, KNOWN TO ME TO BE THE PERSON WHOSE NAME IS SUBSCRIBED TO THE FOREGOING INSTRUMENT AND ACKNOWLEDGED TO ME THAT HE EXECUTED THE SAME FOR THE PURPOSES AND CONSIDERATIONS THEREIN EXPRESSED.
GIVEN UNDER MY HAND AND SEAL OF OFFICE THIS 12 DAY OF August, 1983, A.D.

[Signature]
NOTARY PUBLIC IN AND FOR TRAVIS COUNTY, TEXAS
MY COMMISSION EXPIRES: 11-13-84
DONNA PAIR

BEFORE ME, THE UNDERSIGNED AUTHORITY, ON THIS DAY PERSONALLY APPEARED A.H. ROBINSON, III, KNOWN TO ME TO BE THE PERSON WHOSE NAME IS SUBSCRIBED TO THE FOREGOING INSTRUMENT AND ACKNOWLEDGED TO ME THAT HE EXECUTED THE SAME FOR THE PURPOSES AND CONSIDERATIONS THEREIN EXPRESSED.
GIVEN UNDER MY HAND AND SEAL OF OFFICE THIS 12 DAY OF August, 1983, A.D.

[Signature]
NOTARY PUBLIC IN AND FOR TRAVIS COUNTY, TEXAS
MY COMMISSION EXPIRES: 11-13-84
DONNA PAIR

BEFORE ME, THE UNDERSIGNED AUTHORITY, ON THIS DAY PERSONALLY APPEARED JOHN OSCAR ROBINSON, KNOWN TO ME TO BE THE PERSON WHOSE NAME IS SUBSCRIBED TO THE FOREGOING INSTRUMENT AND ACKNOWLEDGED TO ME THAT HE EXECUTED THE SAME FOR THE PURPOSES AND CONSIDERATIONS THEREIN EXPRESSED.
GIVEN UNDER MY HAND AND SEAL OF OFFICE THIS 12 DAY OF August, 1983, A.D.

[Signature]
RICHARD LILLIE, DIRECTOR OF PLANNING
1983, A.D.
[Signature]
SECRETARY

APPROVED FOR ACCEPTANCE:
DATE: OCT 25, 1983

ACCEPTED AND AUTHORIZED FOR RECORD BY THE CITY PLANNING COMMISSION, CITY OF AUSTIN, TEXAS, OCT 29, 1983, A.D.
[Signature]
CHIEF CLERK
STATE OF TEXAS:
COUNTY OF TRAVIS:

I, DORIS SHROPSHIRE, CLERK OF THE COUNTY COURT, WITHIN AND FOR THE COUNTY AND STATE AFORESAID DO HEREBY CERTIFY THAT THE FOREGOING INSTRUMENT OF WRITING WITH ITS CERTIFICATE OF AUTHENTICATION WAS FILED FOR RECORD IN MY OFFICE ON THE 15th DAY OF November 1983, A.D., AT 10:00 O'CLOCK A.M., IN THE PLAT RECORDS OF SAID COUNTY, IN BOOK 83, PAGES 216C, 216D, 217A.

[Signature]
DORIS SHROPSHIRE, CLERK, COUNTY COURT, TRAVIS COUNTY, TEXAS
[Signature]
DORIS SHROPSHIRE, CLERK, COUNTY COURT, TRAVIS COUNTY, TEXAS

FILED FOR RECORD AT 10:00 O'CLOCK A.M., THIS 15th DAY OF November, 1983, A.D.

I, DORIS SHROPSHIRE, COUNTY CLERK IN AND FOR SAID COUNTY, DO HEREBY CERTIFY THAT ON THE 7th DAY OF November, 1983, A.D., THE COMMISSIONERS COURT OF TRAVIS COUNTY, TEXAS PASSED AN ORDER AUTHORIZING THE FILING OF THIS PLAT AND THAT SAID ORDER WAS DULY ENTERED IN THE MINUTES OF SAID COUNTY OF TRAVIS COUNTY, TEXAS, THIS 7th DAY OF November, 1983, A.D.

[Signature]
DORIS SHROPSHIRE, CLERK, COUNTY COURT, TRAVIS COUNTY, TEXAS

IN APPROVING THIS PLAT BY THE COMMISSIONERS COURT OF TRAVIS COUNTY, TEXAS, IT IS UNDERSTOOD THAT THE BUILDING OF ALL STREETS, ROADS OR OTHER PUBLIC THROUGHFARES OR ANY BRIDGES OR CULVERTS NECESSARY TO BE PLACED ON SUCH ROADS, STREETS, OR OTHER PUBLIC THROUGHFARES SHALL BE THE RESPONSIBILITY OF THE OWNERS AND/OR DEVELOPERS OF THE TRACT OF LAND CONVEYED BY THIS PLAT AND IN ACCORDANCE WITH THE PLANS AND SPECIFICATIONS PRESCRIBED BY THE COMMISSIONERS COURT OF TRAVIS COUNTY, TEXAS, AND SAID COURT ASSUMES NO OBLIGATION TO BUILD ANY OF THE STREETS, ROADS OR OTHER PUBLIC THROUGHFARES OR ANY BRIDGES OR CULVERTS IN CONNECTION THEREWITH.

BE IT RESOLVED BY THE COMMISSIONERS COURT OF TRAVIS COUNTY, TEXAS, THAT THE ACCEPTANCE FOR MAINTENANCE BY TRAVIS COUNTY, TEXAS OF THE ROADS OR STREETS IN REAL ESTATE SUBDIVISIONS DOES NOT OBLIGATE THE COUNTY TO INSTALL STREET MARKING SIGNS, AS THIS IS CONSIDERED TO BE A PART OF THE DEVELOPERS CONSTRUCTION, BUT THAT ERECTING SIGNS FOR TRAFFIC CONTROL, SUCH AS FOR SPEED LIMITS AND STOP AND YIELD SIGNS, SHALL REMAIN THE RESPONSIBILITY OF THE COUNTY.

I, WILEY E. MARK, AM AUTHORIZED UNDER THE LAWS OF THE STATE OF TEXAS TO PRACTICE THE PROFESSION OF SURVEYING, AND HEREBY CERTIFY THAT THIS PLAT COMPLIES WITH CHAPTER 13-3, DIVISION 3, OF THE AUSTIN CITY CODE, OF 1967 AS AMENDED, IS TRUE AND CORRECT TO THE BEST OF MY ABILITY, AND WAS PREPARED FROM AN ACTUAL SURVEY OF THE PROPERTY MADE UNDER MY SUPERVISION ON THE GROUND.

SURVEYED BY: *[Signature]*
WILEY E. MARK, P.E.S. #1931
CARLSON & DIPPEL SURVEYING COMPANY
2499 CAPITAL OF TEXAS HIGHWAY, SUITE 105
AUSTIN, TEXAS 78746

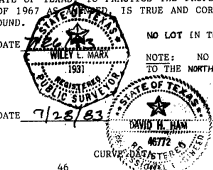

DATE: 7/26/83
NOTE: NO LOT IN THIS SUBDIVISION SHALL BE OCCUPIED UNTIL CONNECTED TO THE NORTH AUSTIN M.U.D. #2 WATER & WASTEWATER SYSTEM.

ENGINEERING BY: *[Signature]*

DAVID H. HAM, P.E.
CARLSON & DIPPEL, INC.
2499 CAPITAL OF TEXAS HIGHWAY, SUITE 105
AUSTIN, TEXAS 78746

42	44	45	46	48	49	50	51
1 11815'	11815'	91235'42"	85952'06"	15700'	15700'	11200'	24215'
R 406.13	466.13	15.00	15.00	1950.36	2020.36	207.71	237.71
T 40.00	45.91	15.42	13.96	256.77	265.98	20.00	24.81
A 79.74	91.52	23.98	22.48	510.60	528.93	39.88	49.48
C 79.61	91.38	21.51	20.43	609.14	527.42	39.81	49.40

32	53	54	56	57	58	59	60	61
1 86°33'52"	91°10'54"	28°16'10"	157°32'20"	101°00'	26°15'	26°15'	06°50'	06°50'
R 15.00	15.00	30.00	50.00	21.69	300.21	330.21	502.49	552.49
T 14.13	15.31	7.55	7.55	36.32	70.00	81.66	30.00	32.98
A 22.66	23.87	14.80	137.48	38.24	137.34	160.45	59.93	65.89
C 20.57	21.43	14.65	33.48	33.48	136.34	159.05	59.89	65.85

82	83	84	85	86	87	88	89	90	91
1 16°31'	16°35'	137°21'40"	24°25'50"	88°30'	06°50'	06°50'	98°30'	81°30'	03°10'
R 480.32	430.38	50.00	30.00	26.80	772.49	822.49	15.00	15.00	1806.88
T 70.00	62.71	-----	8.69	26.11	46.12	49.11	17.41	12.92	30.00
A 139.02	124.55	119.87	12.79	41.40	92.12	98.09	25.78	21.34	99.97
C 138.53	124.11	-----	12.69	37.40	92.07	98.03	22.73	19.58	99.96

72	73	74	75	76	77	78	79	80	81
1 03°10'	14°45'	142°45'	83°30'	144°50'30"	38°40'15"	96°10'30"	22°40'	08°30'	08°30'
R 1858.88	386.30	336.30	34.55	50.00	30.00	15.00	3871.32	350.00	414.00
T 51.38	50.00	43.53	30.82	-----	8.23	16.81	775.95	26.01	30.77
A 102.74	99.45	86.57	50.32	126.40	16.06	26.27	1531.60	51.92	61.42
C 102.72	99.17	86.34	45.98	-----	15.87	27.28	1521.63	51.88	61.36

SIDEWALK NOTE: SIDEWALKS SHALL BE INSTALLED ON BOTH SIDES OF DALLAS DR., THE EAST SIDE OF KERRVILLE FOLKWAY, THE NORTH SIDE OF DIME BOX TR., BOTH SIDES OF AMARILLO AVE., THE SOUTH SIDE OF LOCKENBACH LN., THE SOUTH SIDE OF SHINER ST., AND BOTH SIDES OF CORPUS CHRISTI ST., AND BOTH SIDES OF PARKER LANE.
NOTE: VEHICULAR ACCESS (DRIVENWAYS) PROHIBITED TO PARKER LANE FOR LOTS 1-14 BLOCK G.

CB-82-G3.D1.2 (83)

VAL 83 Page 216C
NOD 15-83 BCHA 2396 * 60.00

VAL 83 Page 216C
NOD 15-83 BCHA 2396 * 60.00

MILWOOD SECTION TWENTY THREE

Vol 83 Page 216 D
PLAT RECORD, TRAVIS COUNTY, TEXAS
NDU 15-83 RCH A 2395 * 60.00

BEING ALL THAT CERTAIN TRACT OR PARCEL OF LAND OUT OF AND A PART OF THE W.J. BAKER SURVEY NO. 10 AND THE W.J. BAKER SURVEY NO. 64, SITUATED IN TRAVIS COUNTY AND WILLIAMSON COUNTY, TEXAS, MORE PARTICULARLY DESCRIBED AS BEING OUT OF AND A PART OF THAT CERTAIN TRACT CONVEYED TO MILWOOD JOINT VENTURE, 11, OF RECORD IN VOLUME 82.e, PAGE 372, OF THE TRAVIS COUNTY, TEXAS DEED RECORDS, SAID TRACT BEING 40.030 ACRES OF LAND MORE FULLY DESCRIBED BY METES AND BOUNDS AS FOLLOWS:

BEGINNING at an iron stake found, from which an iron stake found in the northerly R.O.W. line of McNeil Road, being the southwesterly corner of the MILWOOD 30-1/2 ACRES, 11, bears S 20°04'45"E, 1165.00 feet, to the southwesterly corner of the herein described tract.

THENCE, along the westerly line of the herein described tract, the following three (3) courses and distances, numbered 1 through 3.

1. N 20°44'45"W, 293.48 feet to an iron stake found.
2. N 20°45'00"W, 513.45 feet to an iron stake set.
3. N 12°00'00"W, 255.00 feet to an iron stake set.

for the northwesterly corner of the herein described tract.

THENCE, along the northerly line of the herein described tract, the following nine (9) courses and distances, numbered 1 through 9.

1. N 58°00'00"E, 43.64 feet to a concrete monument set at the beginning of a curve.
2. with curve to the left, whose radius equals 1950.36 feet, an arc distance of 510.60 feet, and whose chord bears, N 50°30'00"E, 509.10 feet to an iron stake set.
3. N 43°00'00"E, 170.00 feet to a concrete monument set.
4. S 47°00'00"E, 70.00 feet to an iron stake set.
5. With curve to the left, whose radius equals 15.00 feet, an arc distance of 23.56 feet, and whose chord bears, S 02°00'00"E, 21.21 feet to an iron stake set.
6. S 47°00'00"E, 50.00 feet to an iron stake set at the beginning of a curve.
7. With curve to the right, whose radius equals 350.21 feet, an arc distance of 115.35 feet and whose sub-chord bears, S 37°33'45"E, 114.83 feet to an iron stake set.
8. N 36°07'15"E, 688.43 feet to an iron stake set.
9. N 44°11'00"E, 120.00 feet to a concrete monument set for the northeasterly corner of the herein described tract.

THENCE, along the easterly line of the herein described tract, the following two(2) courses and distances, numbered 1 through 2.

1. S 45°49'00"E, 188.76 feet to an iron stake set.
2. with curve to the right, whose radius equals 3991.52, an arc distance of 1184.88, and whose sub-chord bears, S 31°18'45"E, 1180.54 feet to an iron stake set for the southeasterly corner of the herein described tract.

THENCE, along the southerly line of the herein described tract, the following twenty-four (24) courses and distances, numbered 1 through 24.

1. S 61°11'30"W, 120.00 feet to an iron stake set.
2. S 66°30'00"W, 303.99 feet to an iron stake found at the beginning of a curve.
3. with curve to the left, whose radius equals 350.00 feet, an arc distance of 51.92 feet, and whose chord bears, S 62°15'00"W, 51.88 feet to an iron stake found.
4. S 58°00'00"W, 84.47 feet to a concrete monument set.
5. N 50°28'15"W, 67.48 feet to an iron stake found at the beginning of a curve.
6. with curve to the left, whose radius equals 150.00 feet, an arc distance of 23.56 feet, and whose chord bears, N 13°00'00"E, 21.21 feet to an iron stake found.
7. N 32°00'00"W, 96.00 feet to an iron stake set.
8. S 58°00'00"W, 110.00 feet to an iron stake set.
9. N 39°30'00"W, 179.56 feet to an iron stake set.
10. N 38°50'00"W, 343.77 feet to an iron stake set.
11. S 62°42'45"W, 203.74 feet to an iron stake set.
12. S 13°15'00"E, 21.54 feet to an iron stake set.
13. S 69°15'00"W, 168.03 feet to an iron stake set.
14. S 20°45'00"E, 90.00 feet to an iron stake set.
15. S 69°15'00"W, 110.00 feet to an iron stake set.
16. S 20°45'00"E, 245.00 feet to an iron stake set.
17. N 69°15'00"E, 35.00 feet to an iron stake set.
18. S 23°14'15"E, 115.11 feet to an iron stake set.
19. S 56°59'00"W, 204.67 feet to an iron stake set.
20. S 69°15'00"W, 110.00 feet to an iron stake set.
21. S 20°45'00"E, 80.00 feet to an iron stake set.
22. S 69°15'00"W, 110.00 feet to an iron stake set.
23. S 64°28'00"W, 60.21 feet to an iron stake set.
24. S 69°15'00"W, 110.03 feet to a concrete monument set, at the PLACE OF BEGINNING, containing 40-030 Acres of Land.

THIS SUBDIVISION HAS BEEN APPROVED BY THE WILLIAMSON COUNTY HEALTH OFFICE FOR 166 LOTS WHICH WILL BE SERVED BY ^{WATER} WITH AUSTIN ^{WATER} #2.

DATE: 08/7/83 Clarence Skrovan, Director
CLARENCE SKROVAN, DIRECTOR

DETENTION NOTE: PRIOR TO CONSTRUCTION ON THIS SUBDIVISION, DRAINAGE PLANS WILL BE SUBMITTED TO THE CITY OF AUSTIN, PUBLIC WORKS DEPT. FOR REVIEW. RAINFALL RUN-OFF SHALL BE HELD TO THE AMOUNT ESTABLISHED BY THE REGIONAL DETENTION PLANS APPROVED BY THE CITY OF AUSTIN. RUN-OFF IN EXCESS OF THE AMOUNT ESTABLISHED FOR THE REGIONAL DETENTION SYSTEM SHALL BE DETAINED BY THE USE OF PONDING OR OTHER APPROVED METHODS.

NOTE: THE UNITED STATES POST OFFICE OF THE CITY OF AUSTIN, TEXAS, HEREBY APPROVES THE STREETS DEDICATED TO THE PUBLIC BY THIS SUBDIVISION PLAT.

DATE: Oct 21, 1983 Paul Bunker
POSTMASTER, CITY OF AUSTIN, TRAVIS COUNTY, TEXAS

NOTE: PRIOR TO GRADING, ANY TYPE OF EARTH MOVING, CONSTRUCTION OF, ON OR UNDER THE LAND IN THIS SUBDIVISION, A DRAINAGE PLAN DESIGNED BY A REGISTERED PROFESSIONAL ENGINEER SHALL BE SUBMITTED FOR THE PROPOSED DEVELOPMENT, AND MODIFICATIONS THEREOF TO THE ENGINEERING DEPARTMENT OF THE CITY OF AUSTIN (WHEN APPLICABLE) AND THE COMMISSIONERS' COURT OF WILLIAMSON COUNTY FOR REVIEW AND APPROVAL.

IN APPROVING THIS PLAT BY THE COMMISSIONERS COURT OF WILLIAMSON COUNTY, TEXAS, IT IS UNDERSTOOD THAT THE BUILDING OF ALL STREETS, ROADS OR OTHER PUBLIC THOROUGHFARES AND ANY BRIDGES OR CULVERTS NECESSARY TO BE CONSTRUCTED OR PLACED IS THE RESPONSIBILITY OF THE OWNER OF THE TRACT OF LAND COVERED BY THIS PLAT, IN ACCORDANCE WITH PLANS AND SPECIFICATIONS PRESCRIBED BY THE COMMISSIONERS COURT OF WILLIAMSON COUNTY, TEXAS AND SAID COMMISSIONERS COURT ASSUMES NO OBLIGATION TO BUILD OR MAINTAIN ANY OF THE STREETS, ROADS, OR OTHER PUBLIC THOROUGHFARES SHOWN ON THIS PLAT, OR OF CONSTRUCTING ANY OF THE BRIDGES OR CULVERTS IN CONNECTION THEREWITH. IT IS FURTHER UNDERSTOOD THAT UPON COMPLETION OF THE AFORESAID OBLIGATIONS OF THE DEVELOPER AND GOT OCCUPANCY OF THE LOTS ALONG THE ROADWAYS AND STREETS IN THE SUBDIVISION HAS BEEN ACHIEVED, AND ALL DRIVEWAY DRAINAGES HAVE BEEN INSTALLED ON WRITTEN PERMISSION FROM THE COUNTY COMMISSIONERS COURT, ASSUMES FULL RESPONSIBILITY FOR MAINTENANCE OF SAID STREETS, ROADS AND DRAINAGE FACILITIES.

IT IS FURTHER UNDERSTOOD THAT THE ENFORCEMENT OF THE PLAT RESTRICTION IS THE RESPONSIBILITY OF THE DEVELOPER/OWNER. HOWEVER, THE CITY AND THE COMMISSIONERS COURT OF WILLIAMSON COUNTY SHALL HAVE THE RIGHT AND AUTHORITY TO ENFORCE THE PLAT RESTRICTIONS THROUGH APPROPRIATE LEGAL PROCEDURE TO PROHIBIT THE CONSTRUCTION, CONNECTION OF UTILITIES OR ISSUING PERMITS UNLESS OR UNTIL THE REQUIREMENTS OF THE PLAT RESTRICTIONS HAVE BEEN ACHIEVED.

STATE OF TEXAS: John Deane Robinson CLERK OF THE COUNTY COURT
COUNTY OF WILLIAMSON: John Deane Robinson CLERK OF THE COUNTY COURT
KNOW ALL MEN BY THESE PRESENTS: I, TIMOTHY MARESH, COUNTY JUDGE OF WILLIAMSON COUNTY, TEXAS, DO HEREBY CERTIFY THAT THIS MAP OR PLAT, WITH FIELD NOTES HEREON, THAT "MILWOOD SECTION TWENTY-THREE", A SUBDIVISION, HAS BEEN FULLY PRESENTED TO THE COMMISSIONERS COURT OF WILLIAMSON COUNTY, TEXAS, AND BY SAID COURT DULY CONSIDERED, WERE ON THIS DAY APPROVED, AND SAID PLAT IS AUTHORIZED TO BE REGISTERED AND RECORDED IN THE PROPER RECORDS OF THE COUNTY CLERK OF WILLIAMSON COUNTY, TEXAS.

DATE: Nov 17, 1983 Timothy Marsh
TIMOTHY MARESH, COUNTY JUDGE, WILLIAMSON COUNTY, TEXAS

STATE OF TEXAS: James N. Boydston CLERK OF THE COUNTY COURT
COUNTY OF WILLIAMSON: James N. Boydston CLERK OF THE COUNTY COURT
KNOW ALL MEN BY THESE PRESENTS: I, JAMES N. BOYDSTON, CLERK OF THE COUNTY COURT OF SAID COUNTY, DO HEREBY CERTIFY THAT THE FOREGOING INSTRUMENT IN WITNESS WHEREOF, WITH ITS CERTIFICATE OF AUTHENTICATION WAS FILED FOR RECORD IN MY OFFICE, ON THE 17th DAY OF November, 1983, A.D., AT 4:50 O'CLOCK P.M., AND DULY RECORDED THIS 17th DAY OF November, 1983, A.D., AT 4:55 O'CLOCK P.M., IN THE PLAT RECORDS OF SAID COURT IN CABINET 2, SLIDES 314-36.

WITNESS MY HAND AND SEAL OF THE COUNTY COURT OF SAID COUNTY, AT MY OFFICE IN GEORGETOWN, TEXAS, THE DATE LAST SHOWN ABOVE WRITTEN.
Barbara Sheffield DEPUTY
James N. Boydston JAMES N. BOYDSTON, CLERK, COUNTY COURT, WILLIAMSON COUNTY, TEXAS

83 17002

Vol 83 Page 216 D
PLAT RECORD, TRAVIS COUNTY, TEXAS

2nd Cond. Recl. 8969 Pg. 303

CB-82-63.01.2 (83)

